

quorum

Model: 8-1400

HANDHELD TRANSMITTER

- Specified DC motor fan use.

NOTE: Each fan will need to be connected to the wall control provided with the fan for the handheld remote to function.

This handheld remote will work with two different types of DC motors. Therefore if the “Pairing Process” doesn’t work, follow the “Control Setting Process” to match handheld remote with fan.

Remove the set screw on the back of transmitter, take out the battery cover. Insert the 3 volt battery (included) and make sure they are seated correctly in each recess with the Positive + sign facing up. When remove or insert the batteries, use a suitable screwdriver to loosen or tighten the screws and open the back cover.

NOTE: To prevent damage to the transmitter, remove these batteries if not used for long periods of time (months).

Setting the Code

Your DC brushless motor is equipped with an automatically learned type remote control. There are no frequency switches on the receiver; the receiver unit will automatically scan the frequency from the transmitter. The fan can start to use once the control setting process is done.

The transmitter unit has frequency settings that can be changed. The frequency settings on the transmitter should only be changed if your fan experiences interference or if a second or more fans with the same type of control system are installed in the same structure. This unit has 16 different code combinations. To set the code, perform these steps:

A. Setting the code on the transmitter:

Slide the code switches to your choice of up or down position. (Factory setting is all up). Do not use this Position. Use a small screwdriver or a ballpoint pen to slide firmly up

Pairing Process

With the fan’s power off, arrange code switches to desired code setting only if the factory pre-set code (all 4 dip switches in “on” position) will not be used. Restore power to the fan. Press and hold “0” button for about 5 seconds and release. If optional light kit is installed, the light kit will flash twice and the signal light on the wall control will come on when the button is pressed. The fan has completed the pairing process with the wall control and is ready for use.

NOTE: The “0” button must be pressed within 60 seconds of restoring power.

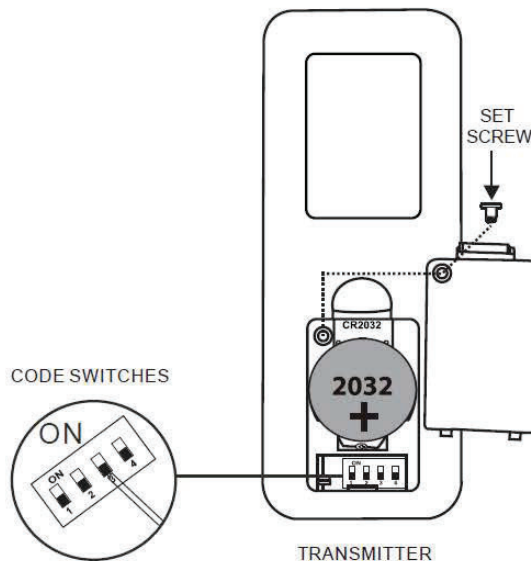

Fig. 1

Operating Instructions

A. 1, 2, 3, 4, 5 and 6 buttons:

These six buttons are used to set the fan speed as follows:

- 1= minimum speed
- 2= low speed
- 3= medium low speed
- 4= medium speed
- 5= medium high speed
- 6= high speed

B. 0 button:

This button turns the fan off.

C. The "☀️" button:

The "☀️" button turns the upper light ON or OFF and also controls the brightness setting. The "🌙" button turns the bottom light ON or OFF. Press and hold the button to set the desired brightness. The light key has an auto-resume, it will stay at the same brightness as the last time it was turned off.

D. The "↺️↻️↷" button is used to set the fan forward or reverse, press the button forward (for warm weather) or reverse (for cool weather).

NOTE: To operate the reverse function on this fan, press the reverse button while the fan is running.

NOTE: The distance between the transmitter and receiver should not be greater than 30 feet. For best performance, make sure the Black Antenna on the end of the receiver unit remains extended and not tangled with any of the electrical wires.

Enjoy Your Smart Ceiling Fan

NOTE: Before moving on to learning about your new smart ceiling fan, please be sure to test all your fans functionalities using your remote control first.

To enjoy all the potential of your new ceiling fan. You'll need to download the BOND HOME app. Available on the Google and Apple Play Store.

You can use the QR code shown in (Fig. 3) to download the app, or you can download the app by visiting https://bondhome_io/app and follow the prompts.

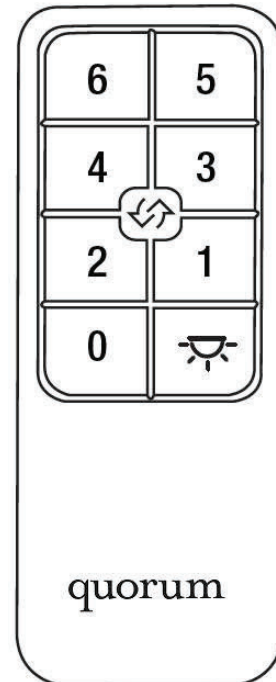

Fig. 2



Fig. 3